

ENHANCED BARRIER PRECAUTIONS

Bed #

Families and visitors:



Please report to staff before entering

Clean hands before entering and when leaving room

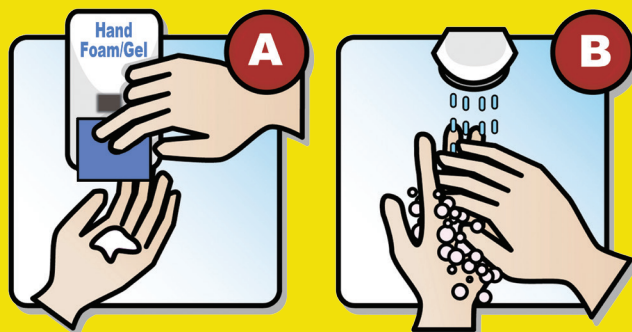

Staff:

Wear gown and gloves for high contact resident care activities:

- Dressing/Bathing/Showering
- Transferring
- Changing Linens
- Changing briefs or assisting with toileting
- Device care or use:
 - urinary catheter
 - feeding tube
 - tracheostomy
- Wound Care: any skin opening requiring a dressing

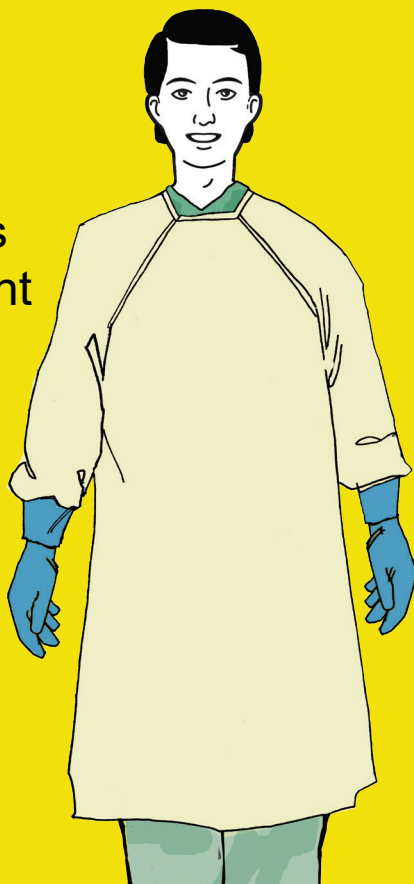

Clean hands with
A) ABHR or **B)** soap and water

Point-of-Care Risk Assessment

When there is a risk of splash or spray, wear face and eye protection.



KEEP SIGN POSTED UNTIL ROOM CLEANED
HOUSEKEEPER will remove sign after "Discharge" cleaning