



Check In

Registration Services staff members are here to help clients check in for their pre-scheduled visits using the self-registration kiosks or with Registration Services staff.

Volunteers are available to help direct clients to the location of programs.

Convenient Services

The on-site Shoppers Drug Mart includes a retail pharmacy for convenient prescription refills and orders.

The on-site Blenz provides food services and seating for over 150 staff and guests. Catering services are also available from Blenz within the Jim Pattison Outpatient Care and Surgery Centre.

Physician Referral

More information about the programs and referral forms are available at:

http://physicians.fraserhealth.ca/resources/outpatient_centre/clinics_and_services

Hours of Operation

Monday to Friday: 7 am to 8 pm
Weekends and holidays: 9 am to 5 pm

Getting Here

Location: 9750 140th Street, Surrey
B.C. V3T 0G9

Phone: (604) 582-4550

Parking: Pay parking is available by credit card or cash.

\$4.25 for the first hour; \$3.50 for each additional hour

Transit options: www.translink.ca or (604) 953-3333

www.fraserhealth.ca



Jim Pattison Outpatient Care and Surgery Centre

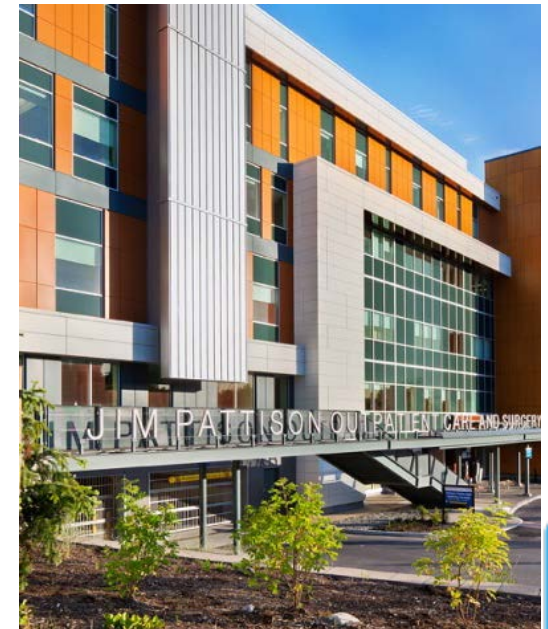

The Jim Pattison Outpatient Care and Surgery Centre strives to create better health within the community as a leading facility in the delivery of outpatient services – a model of patient-centred, evidence-based practices and clinical integration.

Our Services

Jim Pattison Outpatient Care and Surgery Centre provides three major categories of medical service:

- 1) Diagnostic testing
- 2) Specialized medical clinics
- 3) Day surgery and procedures

We serve the community of Surrey, as well as provide some Fraser Health region-wide services.

Diagnostic Testing

- Laboratory Medicine
- Lung Diagnostics
- Diagnostic Cardiology
- Medical Imaging (CT, MRI, bone density, fluoroscopy, ultrasound, mammography, X-ray, echocardiogram, nuclear medicine, interventional radiology)
- Neurodiagnostics (electroencephalogram, electromyography, electrophysiology)

Specialized Clinics

- Anticoagulation Management Clinic
- Breast Health Clinic
- Cardiac Rehabilitation and Prevention*
- Heart Health
- Lipid Clinic
- Diabetes
- Lung Health Services
- Maternity Services*
- Medical Day Care/Ambulatory IV Services
- Neurology Clinic
- Orthopedics and Plastics
- Pain Clinic
- Positive Health HIV/AIDS/HepC*
- Pre-Admission Clinic
- Primary Care
- Renal Vascular Access
- Specialized Seniors
- Urology
- Surrey New Canadian Clinic
- Complex Wound Clinic
- Internal Medicine Clinic
- South Asian Primary Care Clinic
- Provincial Cancer Survivorship Program
- Ambulatory Wound Clinic
- Roshni Addictions Clinic

** These programs may offer patient self-referral. All others require physician referral.*

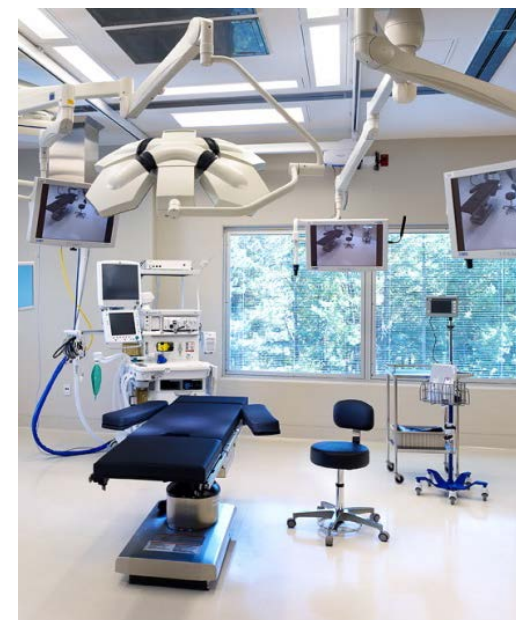

Day Surgery and Ambulatory Procedures

- Surgical ambulatory procedures (endoscopy; urology procedures; colposcopy; minor surgical procedures; minor ear, nose, throat procedures; pain procedures)
- Surgery: six operating rooms (complex ear, nose, throat procedures; pacemaker and other cardiac electrical device implantation; breast mastectomy and reconstruction; orthopedic procedures and others)